

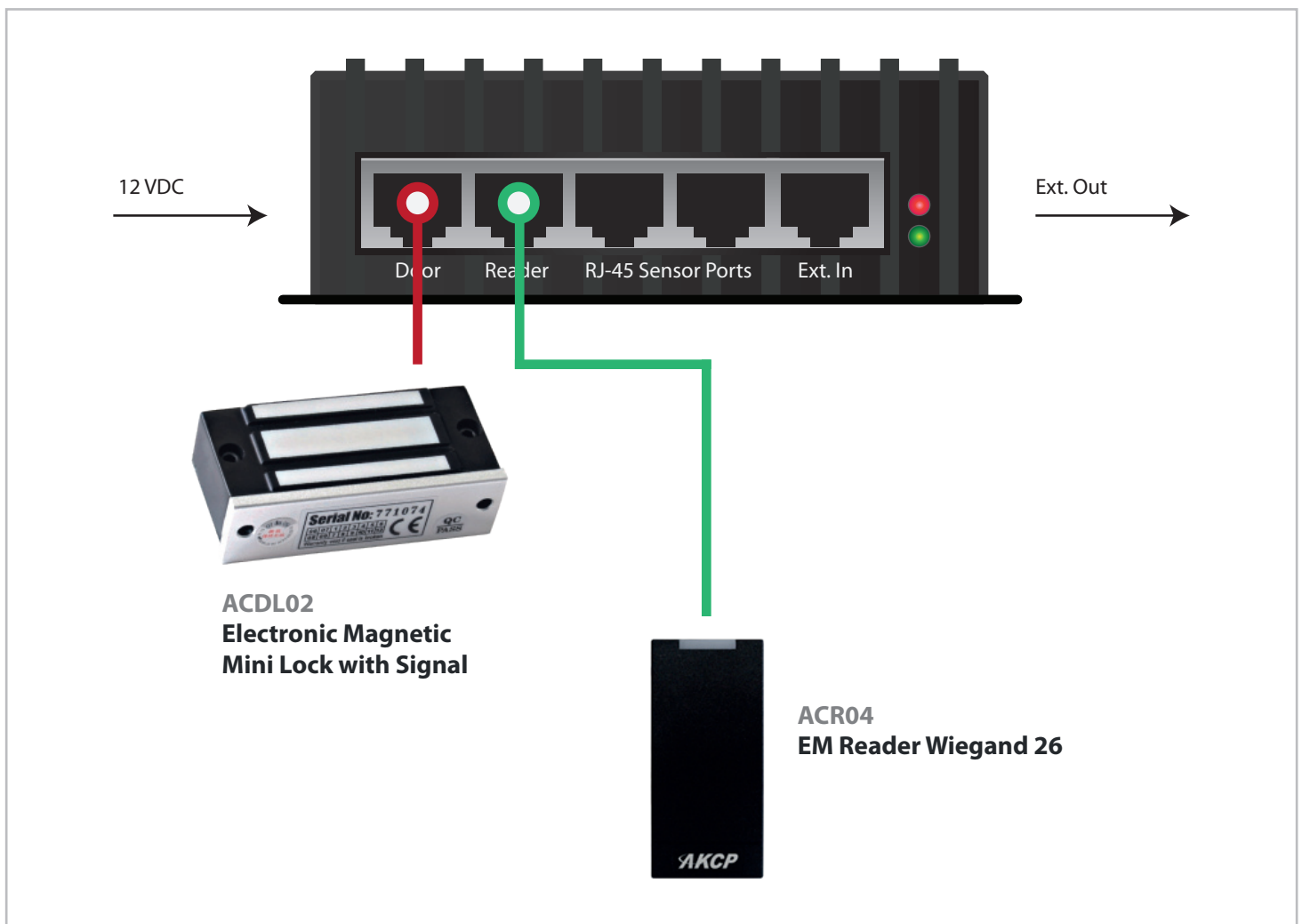

## Cabinet Control Unit

The key component of AKCess Pro's scalability is our Cabinet Controller. Using simple RJ45 connectivity, add locks, readers and exit buttons to a single door or cabinet. Once connected, it's easy to setup the access control parameters for each server cabinet. For large buildings and data centers it's possible to daisy chain the cabinet controllers which grants access control for hundreds of server cabinets.



Our Door & Cabinet Controller works seamlessly with our AKCess Pro Server Management Software providing you with User / Groups Management, User Access Schedules, Advanced Analytics and Notifications, Time-Stamped Video and much more...

## Technical Specifications

Dimension	Expansion Ports	Mounting
Size : 13.20 x 5.38 x 3.40 cm Weight : 0.15 Kg	RJ-45 Expansion Ports IN - OUT Connections	Rack Mount Brackets included Compatible with AKCP's DIN and Rack Mount Trays

Power Requirements	Status Indication	Components
Voltage : 12 VDC, 1Amp	LED Indication for Power LED for Network Connectivity	Manufactured using highly integrated, low power surface mount technology to ensure long term reliability.

Power Consumption	Operating Environment	Inputs
Typical 6 Watt	Temp : Min -35 C° - Max +55°C Humidity : Min 20% - Max 80% (Non-Condensing)	2x RJ-45 Sensor Ports 2x RJ-45 Expansion Ports 1x Card Reader Port 1x Cabinet Lock Port

### MTBF

400,000 Hours